

Data Sheet

Weld-in Thermowells

FEATURES

- One piece bar stock construction
- Stamped with mill traceable material and heat number
- Testing and certifications including Wake Frequency Calculations per ASME PTC 19.3 TW-2016
- Standard or customized shank dimensions

TYPICAL USES

- Chemical and petrochemical plants
- Water and wastewater pressure control
- Pharmaceutical / Biotech
- Food and beverages



Weld-in Thermowells
1½" weld-in sizes

SPECIFICATIONS

Shank Style:	Tapered
Process Connection:	1½"
Instrument Connection:	½ NPSM, ½ NPT Female
Bore Size:	0.260", 0.385"
Surface Finish:	16-32 RA
Lagging:	2": if U-dimension is <3" 3": if U-dimension is >3"
Cap and Chain:	Brass, stainless steel

KEY BENEFITS

- Protects instrument against corrosive effects and physical damage caused by media flow
- Permits instrument interchange or calibration check without disturbing/closing down the process
- Tracing of material origin for quality assurance and control

TABLE 1

OPTIONS	CODE
Stamp tag number on thermowell	NF
Stainless steel tag wired to thermowell	NH
Hydrostatic test-internal	W9
Clean for oxygen service	6B
Wake frequency calculation	W5
CRN stamped on thermowell (includes W5)	UH
Certificates	
Certificate of Conformance (per order)	CD-1A
Physical and Chemical Material Test Report (MTR's)	W6
Positive Material Identification (PMI) N/A Carbon Steel	MQ
NACE Certificate of Compliance	CD-5

TABLE 2

MATERIALS	CODE
304 Stainless steel	C
316 Stainless steel	S
Monel®	M
Hastelloy® B/C	G/H
Carpenter® 20	D
Chrome Moly F11/F22	FA/FB
Duplex 2205 S/S	J
Super Duplex S32750	SD
Inconel® 600	W
Titanium	TI
Carbon Steel	B

Data Sheet

Weld-in Thermowells

ORDERING CODE Example:	15	W	0450	L	H	W	260	SL	1	XNF	L0350
Process Connection Size											
15 - 1½"	15										
Thermowell											
W - Thermowell		W									
U-Process Insertion Length											
0250 - 2½"											
0450 - 4½"			0450								
0750 - 7½"											
1050 - 10½"											
1350 - 13½"											
1650 - 16½"											
2250 - 22½"											
Instrument Connection											
Blank - ½ NPSM											
2 - ½ NPT Female											
T-Lagging											
Blank - No lagging											
L - Lagging (For special lag length, see below)				L							
Shank Type											
H - Tapered					H						
Process Connection											
W - Weld in						W					
D-Bore Diameter											
260 - 0.260"							260				
385 - 0.385"											
Material (Refer to Table 2)											
CL - 304 Stainless steel											
SL - 316 Stainless steel								SL			
Cap and Chain											
Blank - No cap and chain											
1 - Brass									1		
2 - Stainless steel											
Options - (see Table 1 on page 1 for additional options (If choosing an option(s) must include an "X")										X	
NF - Stamp tag number on thermowell											NF
Special Lagging Length											
L - Lagging length × 100 (ex: 3.5" × 100 = L0350)											L0350

Data Sheet

Weld-in Thermowells

DIMENSIONS

For reference only, consult Ashcroft for specific dimensional drawings

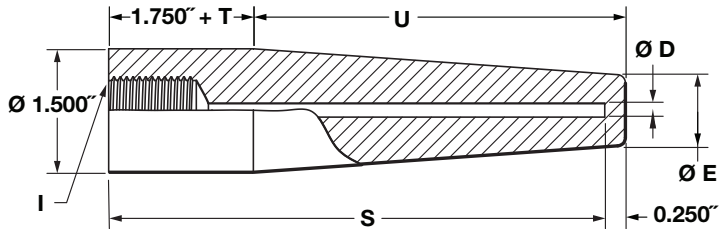

DIMENSION (Inches)		Weld-In	
S	U	D	E
4	2½	0.260"	0.625"
6	4½	0.385"	0.766"
9	7½		
12	10½		
15	13½		
18	16½		
24	22½		

Thermowell Legend

I - Instrument connection (½" NPSM STD.)

E - Tip O.D.

D - Bore diameter

U - Insertion depth

S - Instrument stem length or bore depth